

If In Doubt ASK !

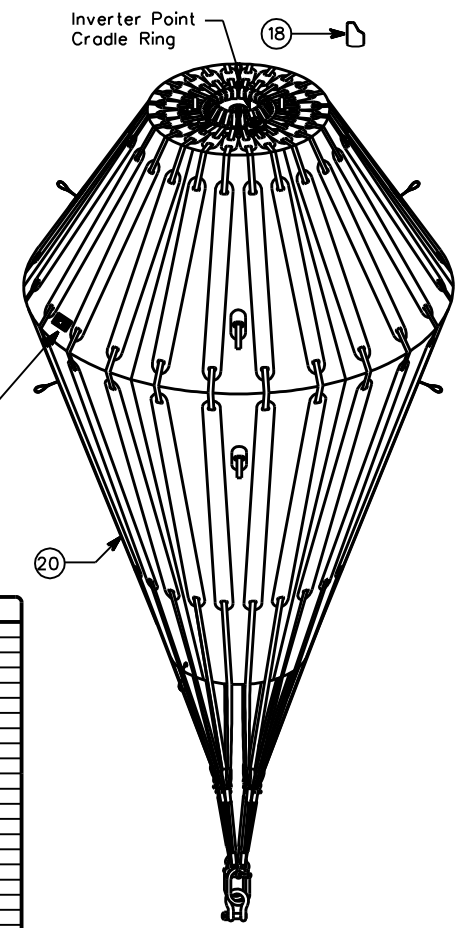
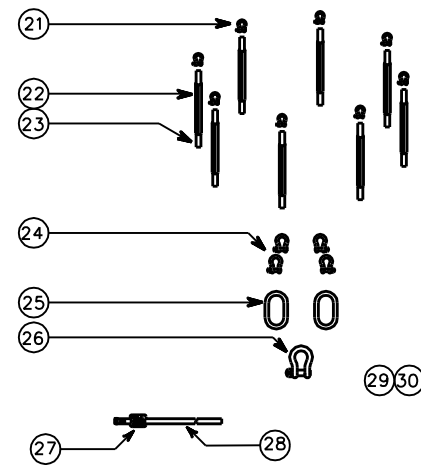
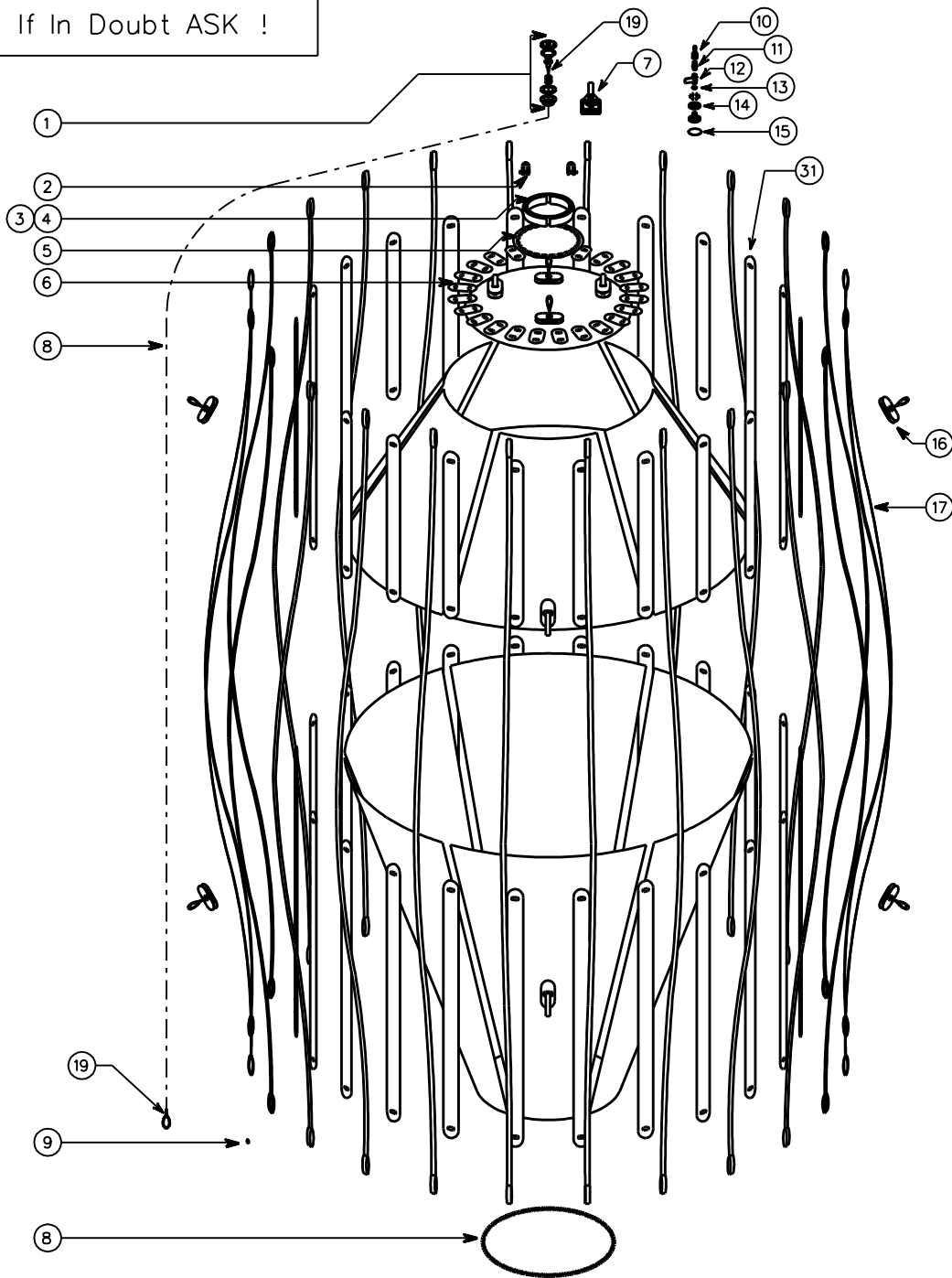

Item No.	Part No	BAAW	Qty	Description	Remarks
1	0043300000	71044	1	Large Dump Valve	
2	00601510851	711324	2	D Type Shackle	8.3T SWL
3	E0201709217	711319	1	Cradle Strap	1450mm BT SWL
4	E0201709218	711320	1	Cradle Strap	1650mm BT SWL
5	E0108031800	710280	1	Cradle Guide	24 Hole
6	N/A	N/A	24	Strap Guide	
7	E0102030819	711729	1	Inverter Point Label	Harness
8	00317050001	710729	15m	6mm Rope	
9	00500590400	710213	1	Weldable Eyelet	15/37 IN
10	00448351240	711142	1	Stress Coupling	3/4" Hose Tab
11	00448351230	711158	1	Stress Coupling	3/4" BSP Male
12	00444058116	710264	1	Ball Valve	3/4" BSP
13	00413562900	711092	1	Brass Nut	3/4" BSP
14	00412560160	711143	1	3/4" Skin Fitting	3/4" BSP
15	E0108031600	710276	1	Inlet Patch	
16	E0108031500	710273	12	Anchor Tab	
17	E0201709219	711321	24	Duplex Side Strap	3T SWL 75mm Wide
18	E0108038800	710199	1	External Cover	
19	00500539012	710250	2	Crimped Copper Ferrule	
20	00108039999	710370	57m	Yellow Material	3 x 3
21	00601510400	710773	8	Shackle	9.5T SWL
22	E0201709216	711318	8	Round Ring	800mm BT SWL
23	N/A	711595	8	Large Sleeve	
24	00601510550	710767	4	Shackle	17 T SWL
25	00602510905	710786	2	Steel Link	38.3T SWL
26	00601510551	711323	1	Shackle	55.0 T SWL
27	E0102038010	N/A	1	Major Tie Strap Label	Yellow PVC
28	E0202708800	710690	1	Tie Strap	Major Extra Large
29	E0102030816	N/A	1	Jet Label	Blue PVC
30	E010175800	710202	1	Label Cover	Clear PVC
31	F402	710735	8	Screen Print	Strap Panel

BAAW No.	711317
File Name	PR50.DGN

Dimensions in MM	
Tolerance	Material
N/A	N/A

©SCHOLLE EUROPE LIMITED Ltd
 J.W. Automarine 1972-2009. This article and drawing is protected by copyright and is the property of Scholle Europe Limited. It may not be copied, published, or used for any purpose other than that for which it has been supplied, except with the written permission of Scholle Europe Limited.

SCHOLLE EUROPE LTD.
 J.W. Automarine
 Fakenham, Norfolk, NR21 8SN, England
 Telephone: Fakenham 013281852300
 Fax: Fakenham 013281864222
 Email: sales@jwautomarine.co.uk

Drawn	Sig	Revisions	Issue	Date	Client
SBC		Inverter Point	1	17.3.06	J.W. Automarine
			2	7.5.08	
Scale					Drawing No C/JW 03/08B Issue No 2
N.T.S.					
Checked					

Overall Height	7300mm
Overall Diameter	5000mm
Lift Capacity	50000Kg

Title
 PR50 (50000 Kg)