

If In Doubt ASK !

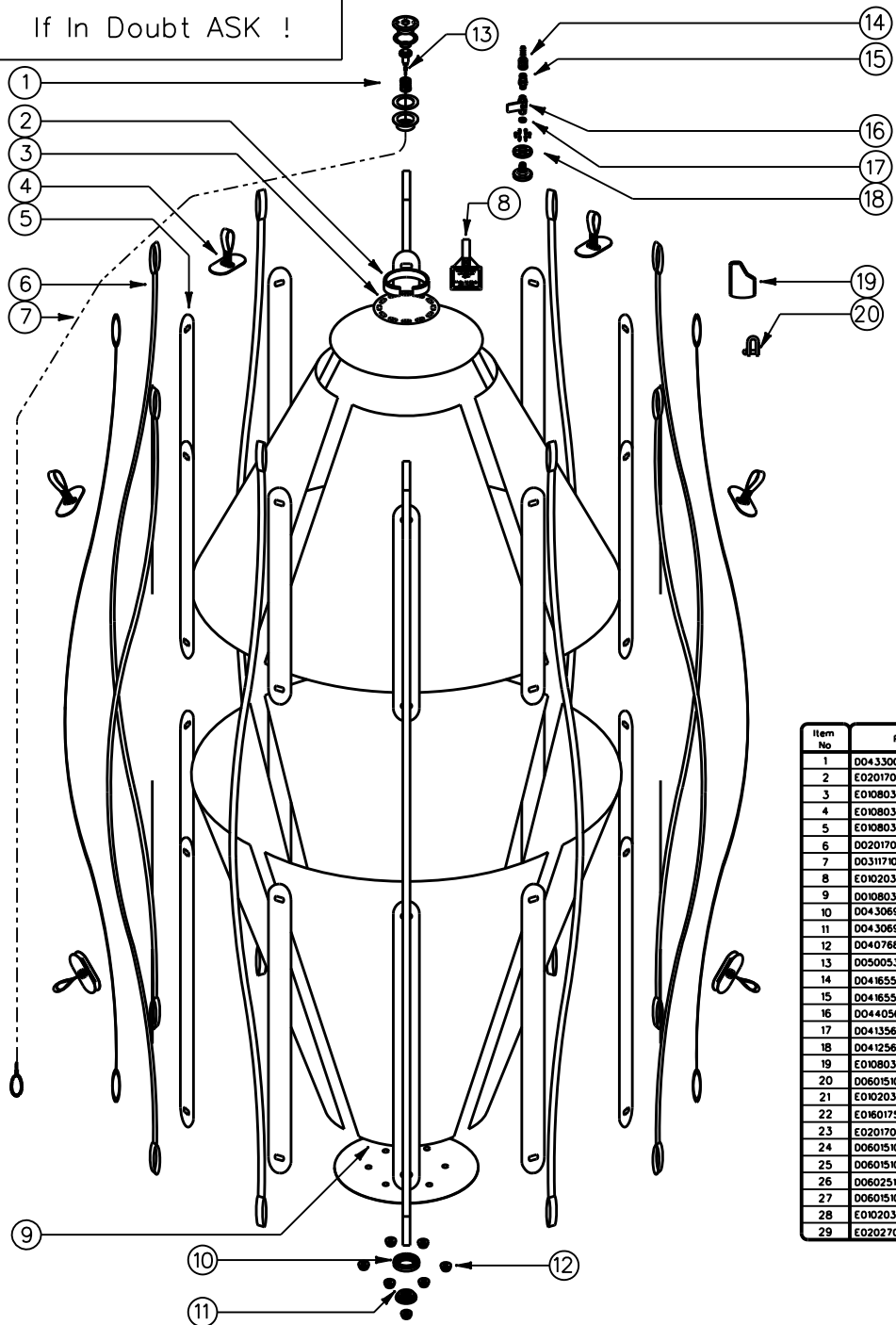

Overall Height	4850mm
Overall Diameter	2760mm
Lift Capacity	10000Kg

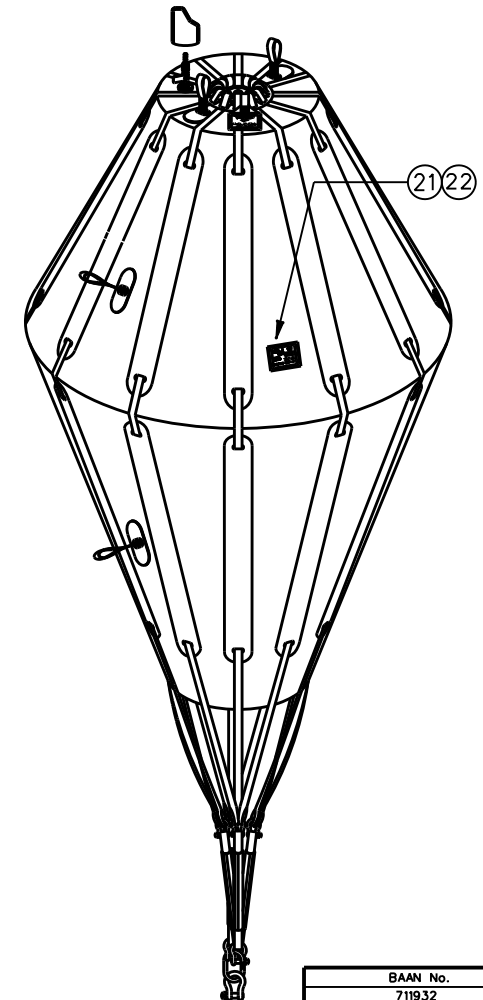
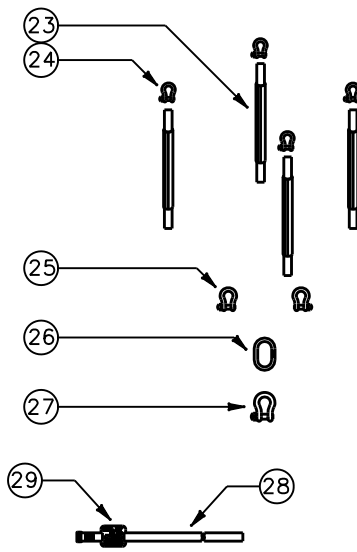

Item No	Part No	BAAN	Qty	Description	Remarks
1	D043300000	711044	1	Large Dump Valve	
2	E0201709213	711764	1	Cradle Strap PR10	Rnd Sing 3T SWL 750mm EWL
3	E0108032200	710278	1	Cradle Patch	PR3 PR5 PR10
4	E0108031500	710273	6	Anchor Tab Major	
5	E0108033115	710193	4	Screen Patch	Type 7
6	D0201709215	711765	12	PR10 Side Straps	Duplex Strap 1T SWL 5m EWL
7	D0311710001	710729	8.3m	6mm Rope	
8	E0102030819	711729	1	Inversion Point Label	On Harness
9	D0108039999	710370	14.14m	Yellow Material	3 x 3
10	D0430690018	710977	1	4" Skin Fitting	
11	D0430690020	710966	1	4" Plug	To Take AID Valve
12	D0407683310	711131	7	AID Relief Valve	1 P.S.I.
13	D0500539012	710250	2	Crimped Copper Ferrule	
14	D0416551240	711142	1	Bross Coupling	Hose Tail
15	D0416551230	711158	1	Bross Coupling	3/8 BSP Male
16	D0440561316	710964	1	St/Sil Ball Valve	3/8 BSP
17	D0413562900	711092	1	Bross Nut	3/8 BSP
18	D0412560160	711143	1	3/4" Skin Fitting Male	3/8 BSP
19	E0108038800	710199	1	External Cover	
20	D0601510305	710775	1	Shackle For Cradle	D Type 6.5 T SWL
21	E0102030816	N/A	1	JW Label	Blue PVC
22	E0102030816	710202	1	Label Cover	Clear PVC
23	E0201709212	711763	4	Bottom Strap	Round Sing 3T SWL 700mm
24	D0601510602	711787	4	Shackle	4.75 T SWL
25	D0601510603	711788	2	Shackle	6.50 T SWL
26	D0602510904	710783	1	Steel Link	11.4 T SWL
27	D0601510605	711890	1	Shackle	12.0 T SWL
28	E0102036010	N/A	1	Tie Strap Label	Blue PVC
29	E0202708900	710903	1	Tie Strap	Major

BAAN No.		711932	
File Name		PR10TE.DGN	
Dimensions In MM		Tolerance	
N/A		N/A	
© SCHOLLE EUROPE LIMITED 1/0		J.W. Automarine 1972 - Present. This article and drawing is protected by copyright and is the property of Scholle Europe Limited. It may not be copied, published, or used for any purpose other than that for which it has been supplied, except with the written permission of Scholle Europe Limited.	
SCHOLLE EUROPE LTD.			
Enverton Way		Folkeham Nor Igh AR21 BSH England	
Telephone Folkeham 01323 852300		Folkeham 01323 854222	
Fax		Sales@jwautomarine.co.uk	
Client		JW Automarine	
Drawn	Sig	Revisions	Issue Date
		1	23.4.96
Scale	SBG	No. Of Valves	3
1:18			7.1.09
Checked			
On A1			
Sheet No	CJW 96/086	Issue No	3
Sheet No	1 Of 1	Date	7.1.09