

If In Doubt ASK !

Overall Height	3950mm
Overall Diameter	1500mm
Lift Capacity	3000Kg

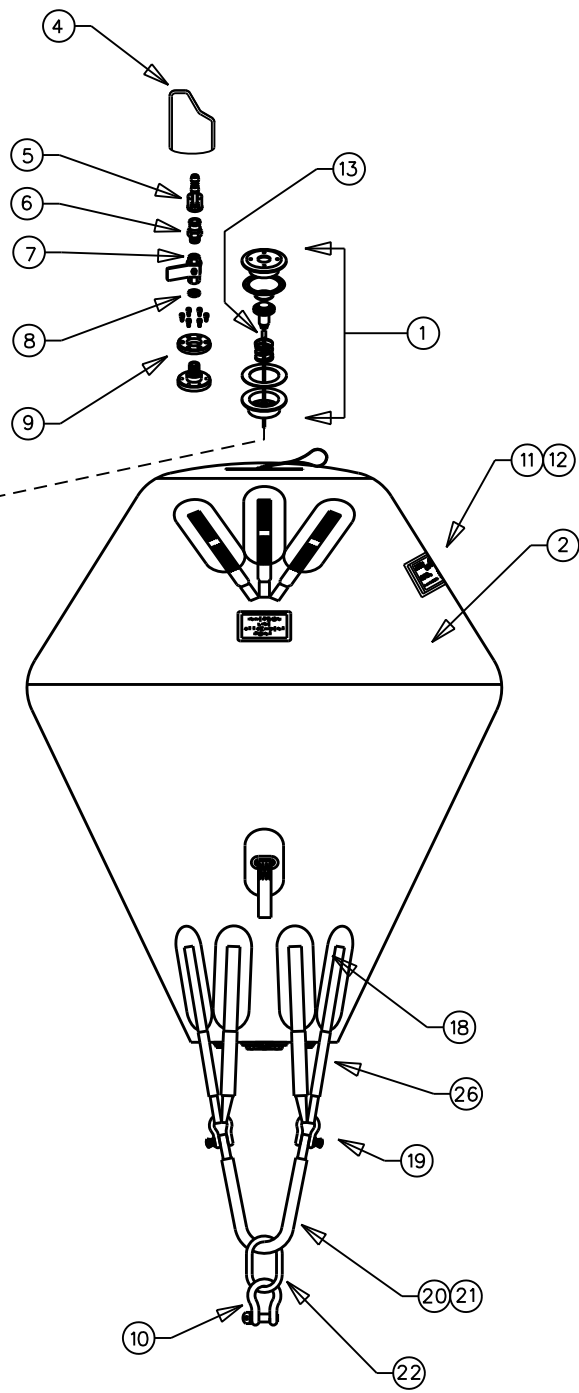

Item No	Part No	BAAN No	Qty	Description	Remarks
1	D0433000000	711044	1	Large Dump Valve	
2	D0108039999	710370	6.5m	Yellow Material	3 x 3 P.V.C.
3	E0108031500	710273	5	Anchor Tab	Major
4	E0108038800	710199	1	External Cover	
5	D0416551240	711142	1	Brass Coupling	Hose Tail
6	D0416551230	711158	1	Brass Coupling	3/4BSP Male
7	D0440561316	710964	1	St/Stl Ball Valve	3/4BSP
8	D0413562900	711092	1	Brass Nut	3/4BSP
9	D0412560160	711143	1	3/4" Skin Fitting Male	
10	D0601510300	710760	1	Shackle	6.5T S.W.L.
11	E0102030816	710260	1	JW Label	Blue PVC
12	E0160175800	710202	2	Label Cover	Clear PVC
13	D0500539012	710250	2	Crimped Copper Ferrule	6.5mm
14	D0311700001	710729	5.9m	6mm Rope	
15	D0430690018	710977	1	4" Skin Fitting	
16	D0430690021	710974	1	4" Plug	To Take A10 Valve
17	D0407683320	711127	4	A10 Relief Valve	
18	E0201700403	711255	8	PR3 Side Straps	New Style
19	D0601501000	710762	4	Shackle	3.25T S.W.L.
20	E0201709223	711950	2	Bottom Strap	Round Sling 2T 0.7m
21	E0108031303	711295	2	Large Sleeve	
22	D0602510902	710765	1	Steel Link	6.5T S.W.L.
23	E0202708900	710903	1	Tie Strap	
24	E0102036010	N/A	1	Major Tie Strap Label	Blue PVC
25	E0201700402	711525	3	PR5 Side Strap	Inverter Point
26	E0104031201	711264	8	Sleeve	Medium
27	E0102030818	711718	1	Inverter Point Label Lrg	Yellow PVC

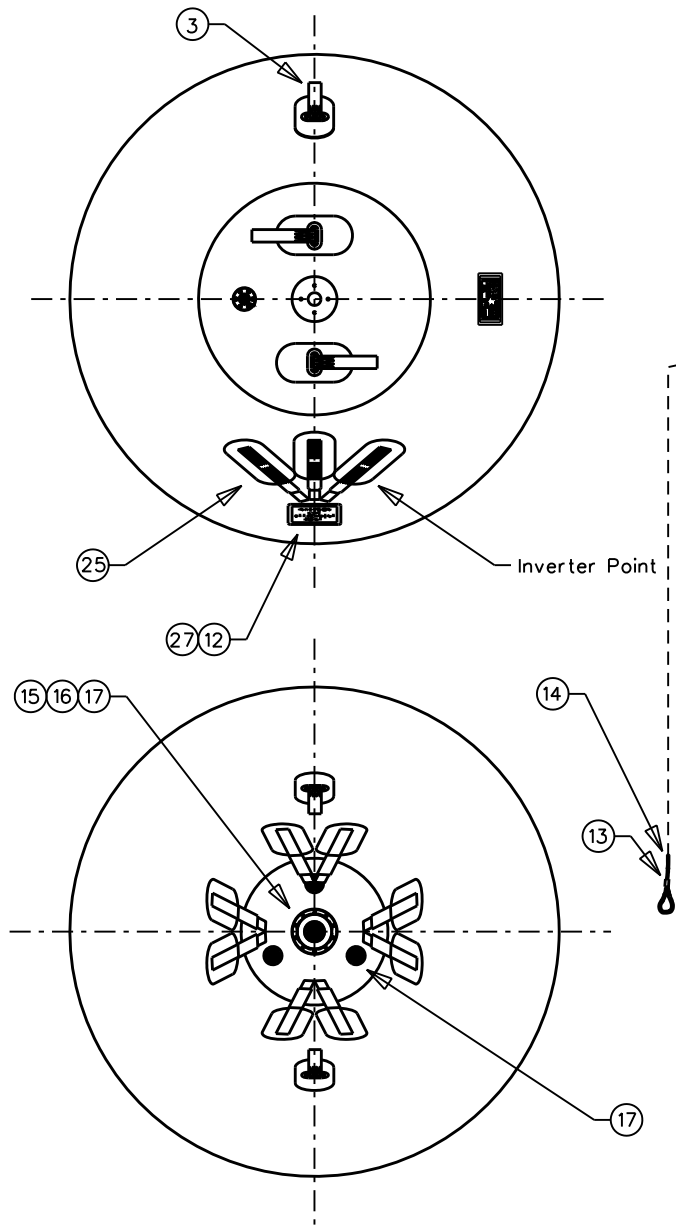
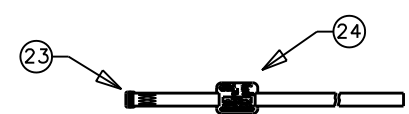

Dimensions in MM	
Tolerance	N/A
©SCHOLLE EUROPE LIMITED 1/0 J.W. Automarine 1972 - Present. This article and drawing is protected by copyright and is the property of Scholle Europe Limited. It may not be copied, published, or used for any purpose other than that for which it has been supplied, except with the written permission of Scholle Europe Limited.	

BAAN No.	711661
File Name	PR3TE.DGN
Material	See Parts List

SCHOLLE EUROPE LTD.
100
Automarine
Enterprise Way
Fakenham, Norfolk, NE21 6SN, England
Telephone: Fakenham 01328 852300
Fakenham 01328 854222
sales@jwautomarine.co.uk

Drawn	Sig	Revisions	Issue	Date
SBG		Drawn	1	12.12.06
		Inverter Point	2	29.10.07
		Round Sling	3	9.4.10
Scale				
1:11				
On A1				
Checked				

Client			
J.W. Automarine			
Drawing No	CJW 06/065	Issue No	3
Sheet No	1 Of 1	Date	9.4.10

Title
3000kg Totally Enclosed Parachute Bag PR3TE